

Intravenous (IV) medication administration (gravity drip method) Home Care Guidelines



Consultation, training and service

1-800-30-68-68

www.homecure.co.il

Name of the treating nurse: _____ Phone No. _____
Name of the treating physician: _____ Phone No. _____

Written by Ruthy Amrani, Director of Home Cure Division, Neopharm;
Professional consultation – Fruma Tzur, M.Sc., RN, Meir Hospital
The information presented in this leaflet is for informational purposes only and does not
replace professional medical advice
All rights reserved to Neopharm - Do not copy and/or use for any commercial purpose
without receiving permission in writing from Neopharm



Awareness to flaws and defects

Intravenous (IV) medication administration (gravity drip method)
If you are not sure that, the system is working properly or if you encounter any
problem during treatment – contact the treating staff

Problem	Treatment
Cloudiness of medication in the bag (discoloration, appearance of lumps)	<ul style="list-style-type: none">Do not use the bag.If the problem occurs during medication administration stop treatment immediatelyKeep the bag for inspection and contact the treating staff
Leakage from the bag	<ul style="list-style-type: none">Do not use the bag, but keep for inspection
The infusion is not draining/ catheter occlusion	<ul style="list-style-type: none">Ensure that the flow regulator is openEnsure there is no bending or folding of the catheterRaise the bag higherEnsure there is fluid in the drip chamberDisconnect the medication tube from the catheter plug and connect a red plug to the tube – ensure to perform under sterile conditionsGently perform catheter flushing using a saline or heparin syringe – according to the instructions; if is experienced resistance to flow of fluid – disconnect the flushing system and contact the treating staff/ physicianAfter flushing is completed– follow instructions to reconnect to the medication bag
Appearance of air in the tube	<ul style="list-style-type: none">Close the flow regulatorDisconnect the infusion from the catheter plugRemove air from the system according to the instructionsRestart the connection process
Blood in the infusion system	<ul style="list-style-type: none">Ensure there is still a solution in the bagEnsure the drip chamber is half full with fluid, and that the infusion set is flushed with the solutionEnsure the bag is at the correct heightIf you completed the infusion, proceed according to the catheter flushing plan
Catheter is dislodged	Place a sterile gauze pad dressing on the connection site and contact the treating staff
External tear / disconnection in the catheter	Immediately close with the clamp, as close as possible to the body, and contact the treating staff
Pain, tenderness, redness or swelling at the infusion site	Stop medication administration and contact the treating staff
Rash, dizziness, chills, fever above 38 °C or any adverse effect	Stop medication administration and contact the treating staff
Leakage from the plug	Replace the plug

Dear patient,

The Home Cure Division and the treating staff wish you rapid recovery and success in your home care. This information leaflet is designed to help you perform IV treatment at home, as prescribed by your physician and after receiving instructions from the professional staff.
This leaflet describes the treatment stages and helps you perform self-care at home.

Treatment Principles

- Maintain hygiene during treatment
- Follow the treatment stages
- Protect the catheter and auxiliary equipment
- Take the medicine at specific times as prescribed by your doctor

Handling medication in the infusion bag

It is important to ensure proper maintenance of the infusion bag according to the pharmacy's instructions - at room temperature, in the refrigerator or in the freezer.
a. If the drug is kept in the refrigerator – take it out approx 2 hours before use.
b. If the drug is kept in the freezer– transfer it to the refrigerator approx 24 hours before use, and take it out of the refrigerator approx 2 hours before use.
c. **Do not heat the infusion bag - do not heat it in a microwave oven or in any other heating device.**

Examining the medication bag

- ✓ Verify that your name and ID No. on the infusion bag label are correct
- ✓ Verify that the name of the drug and the dosage specified on the bag correspond to the physician's instructions
- ✓ Verify the expiration date (**always use the medication bag with the closest expiration date**)
- ✓ Ensure the solution is clear
- ✓ Ensure the infusion bag is intact and there is no leakage

Required Equipment

- Medication bag
- Sterile pads
- Infusion set
- Infusion pole
- Sterile sheet
- Sterile gloves and mask
- Bottle of Alcoxidine (70% alcohol+0.5% Chlorhexidine)
- Syringes for catheter flushing – heparin and/or saline (NaCl 0.9%) and garbage bag



Sequence of actions for drug administration
By connecting to in peripheral catheter
Required equipment

- Medication bag
- Infusion pole
- Infusion set
- Sterile pads
- Garbage bag
- Bottle of Alcoxidine (70% alcohol+0.5% Chlorhexidine)
- Syringes for catheter flushing – heparin and/or saline (NaCl 0.9%)

Connecting the infusion set to the medication bag

1. Wash your hands with water and soap and dry them with a clean personal towel
2. Place the equipment on a clean surface
3. Take the infusion set out of the package
4. Close the flow regulator on the set downwards
5. Remove the plastic plug from the medication bag by rotating (on the connecting tube)
Do not touch the exposed parts of the set and the bag
6. Remove the cover from the tip of the spike infusion set
7. Insert the tip of the spike infusion set into the medication bag (by pressing and rotating)

Removing air from the infusion set / Filling the set with solution

8. Hang the medication bag on the pole
9. Press the drip chamber and fill it with fluid to half its volume
10. **Slowly** open the flow regulator upwards and let the fluid flow through the tube; ensure there is no air in the system
11. Close the flow regulator downwards

Connecting the medication bag

12. Disinfect the catheter plug in your arm using a gauze pad soaked in Alcoxidine
13. Take the syringe out of the package, remove the cover from the syringe and place it alongside the surface
14. Ensure there is no air in the syringe
15. Connect the syringe to the catheter plug in your arm (by pressing and rotating)
16. **Slowly** inject the syringe contents
17. Disconnect the syringe from the plug by rotating and discard the syringe in the garbage bag
18. Remove the cover at the tip of the infusion set that is connected to the medication bag
Do not touch the exposed parts of the set and the bag
19. Connect the tip of the infusion tube to the catheter plug in your arm (by pressing and rotating)
20. Set the drip rate using the flow regulator according to the instructions you received

Disconnecting from the medication bag

21. Wash your hands with water and soap and dry them with a clean personal towel
22. After finishing the entire solution contained in the bag, close the flow regulator
23. Disconnect the infusion set from the catheter plug in your arm by rotating
24. Discard the bag and infusion set in the garbage bag

Catheter flushing

25. Disinfect the catheter plug in your arm using a gauze pad soaked in Alcoxidine
26. Remove the cover from the flushing syringe
27. Ensure there is no air in the syringe
28. Connect the syringe to the catheter plug in your arm (by pressing and rotating)
29. **Slowly** inject the syringe contents
30. Disconnect the syringe from the catheter plug by rotating, and discard the syringe in the garbage bag
31. If medical instructions call for a heparin flush - perform another flush procedure
32. If medical instructions call for a heparin flush - perform another flush procedure

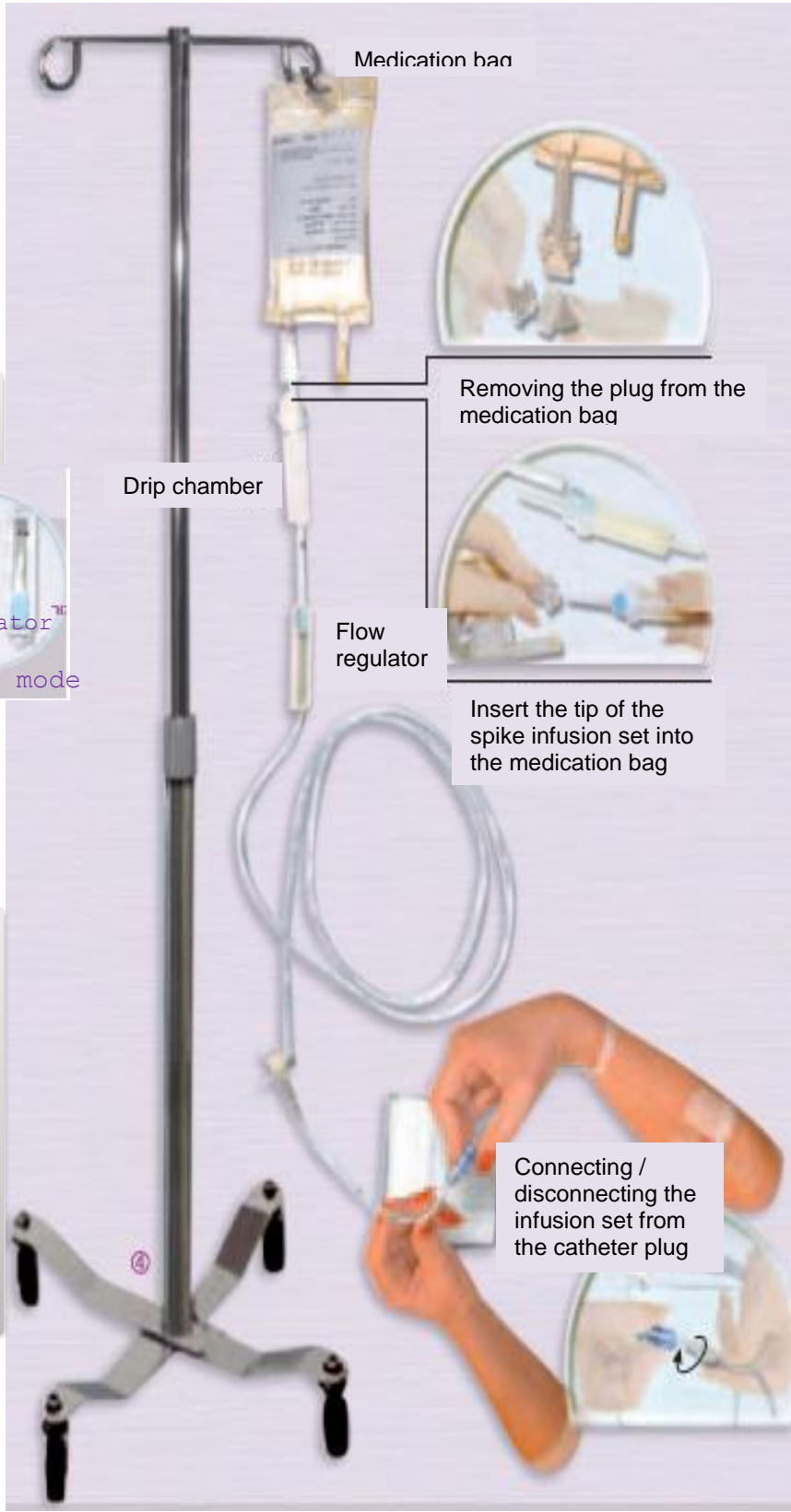

- 2.11 Disinfect the catheter plug using a gauze pad soaked in Alcoxidine - three times, using a new pad each time
- 2.12 Take the syringe out of the package, remove the cover from the syringe and place it alongside the surface
- 2.13 Ensure there is no air in the syringe
- 2.14 Connect the syringe to the catheter plug (by pressing and rotating)
- 2.15 Open the clamp on the catheter (if applicable)
- 2.16 **Slowly** inject the syringe contents
- 2.17 Close the clamp on the catheter (if applicable)
- 2.18 Disconnect the syringe from the catheter plug by rotating, and discard the syringe in the garbage bag
- 2.19 If medical instructions call for a heparin flush - perform another flush procedure

You have completed medication administration

Sequence of actions for drug administration
By connecting to in central catheter

The Infusion set connection stage to medication bag

Required equipment

- Medication bag
- Infusion pole
- Bottle of Alcoxidine (70% alcohol + 0.5% Chlorhexidine)
- Syringes for catheter flushing – heparin and/or saline (NaCl 0.9%)
- Infusion set
- Garbage bag

Connection set contains

- Sterile gauze pads
- Sterile sheet + sterile gloves and mask

Sequence of actions

- 1.1 Wash your hands with water and soap and dry them with a clean personal towel
- 1.2 Place the equipment on a clean surface
- 1.3 Take the infusion set out of the package
- 1.4 Close the flow regulator on the set downwards
- 1.5 Remove the plastic plug found on the medication bag by rotating (in the tube intended for the connection) **Do not touch the exposed of the set and the bag**
- 1.6 Remove the cover from tip of the spike infusion set
- 1.7 Insert the tip of the spike infusion set into the medication bag by rotating
- 1.8 Hang the medication bag on the pole
- 1.9 Press the drip chamber and fill it with fluid to half its volume
- 1.10 **Slowly** open the flow regulator upwards so the fluid can flow through the tube; make sure there is no air in the system
- 1.11 Close the flow regulator downwards
- 1.12 Wear a mask (in accordance with the policy)
- 1.13 Spread the sterile sheet
- 1.14 Open the package of sterile pads without touching the contents, place them on the sterile sheet and pour Alcoxidine on them
- 1.15 Open the package of gloves and put them on while maintaining sterile conditions
- 1.16 Disinfect the catheter plug using a gauze pad soaked in Alcoxidine - three times, using a new pad each time
- 1.17 Take the syringe out of the package, remove the cover from the syringe and place it alongside the surface
- 1.18 Make sure there is no air in the syringe and connect it to the catheter plug (by pressing and rotating)
- 1.19 Open the clamp (if applicable)
- 1.20 **Slowly** inject the syringe contents
- 1.21 Close the clamp (if applicable)
- 1.22 Disconnect the syringe from the catheter plug by rotating, and discard the syringe in the garbage bag
- 1.23 Remove the cover at the tip of the infusion set that is connected to the medication bag
- 1.24 Connect the tip of the infusion tube to the catheter plug (by pressing and rotating)
- 1.25 Open the clamp (if applicable)
- 1.26 Set the drip rate using the flow regulator according to the instructions you received

Infusion set disconnecting stage

Required equipment

- Bottle of Alcoxidine (70% alcohol + 0.5% Chlorhexidine)
- Syringes for catheter flushing – heparin and/or saline (NaCl 0.9%)

Connection set contains

- Sterile gauze pads
- Sterile sheet + sterile gloves and mask

Sequence of actions

- 2.1 Wash your hands with water and soap and dry them with a clean personal towel
- 2.2 Close the flow regulator
- 2.3 Close the clamp that is on the catheter (if applicable)
- 2.4 Wear a mask (in accordance with the policy)
- 2.5 Spread the sterile sheet
- 2.6 Open the package of sterile pads without touching the contents, place them on the sterile sheet and pour Alcoxidine on them
- 2.7 Open the package of gloves under sterile conditions
- 2.8 Put the gloves on under sterile conditions
- 2.9 Hold the infusion set with sterile gauze and disconnect it from the catheter plug by rotating
- 2.10 Discard the set with the bag in the garbage bag

Do not touch the exposed equipment

Aseptic Technique

Aseptic Technique

Aseptic Technique

Aseptic Technique

Aseptic Technique